

DESCRIPTION AND OPERATION

Clutch Controls

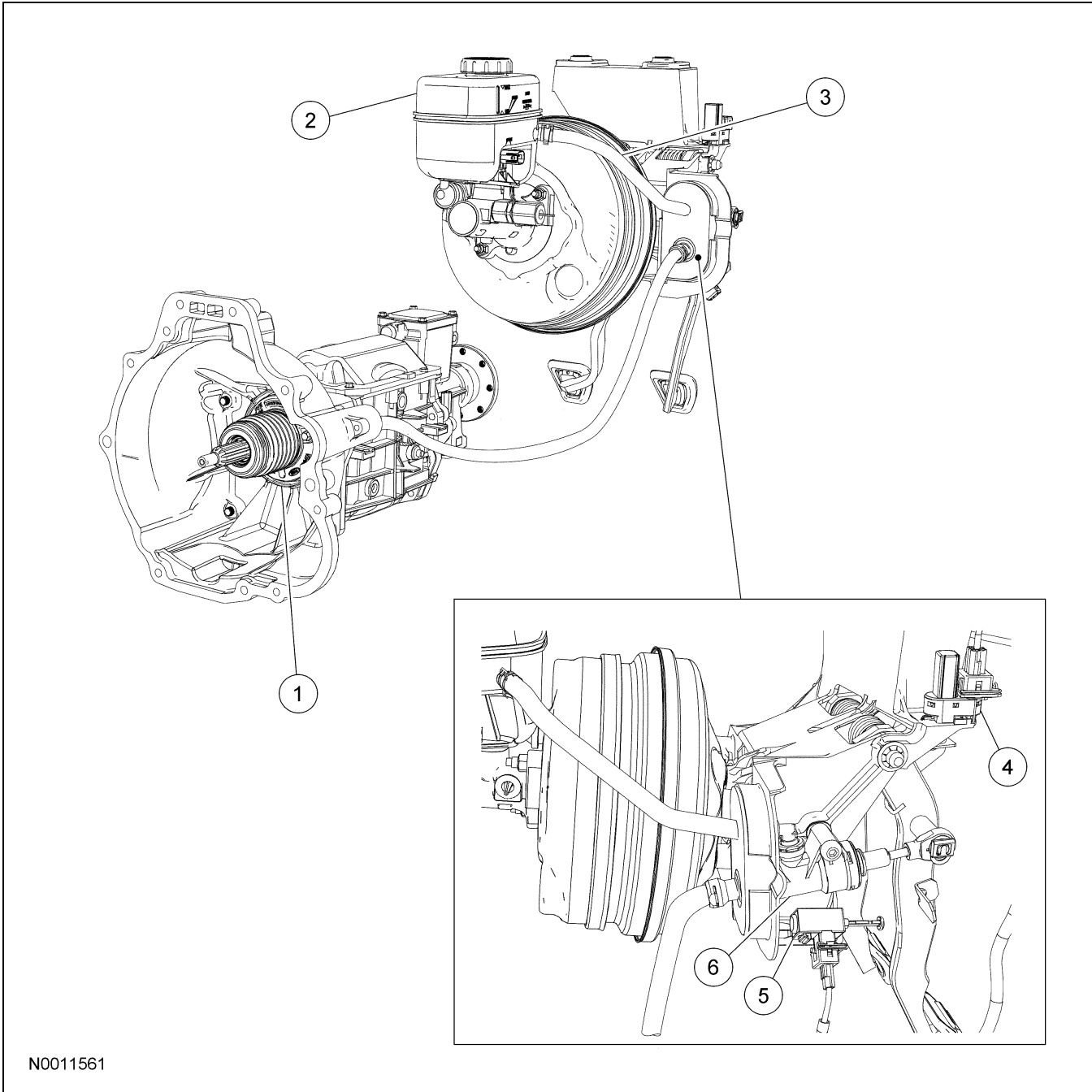

N0011561

Item	Part Number	Description
1	7A508	Clutch slave cylinder
2	—	Brake and clutch reservoir
3	—	Reservoir to clutch master cylinder hose

Item	Part Number	Description
4	7C534	Cruise control switch
5	11A152	Clutch pedal position (CPP) switch
6	7A543	Clutch master cylinder

(Continued)

DESCRIPTION AND OPERATION (Continued)

The clutch control system actuates the clutch system. The clutch control system disengages the clutch when the clutch pedal is depressed and engages the clutch when the clutch pedal is released. When the clutch pedal is depressed it pushes the clutch master cylinder plunger, which transmits hydraulic pressure to the clutch slave cylinder. The clutch slave cylinder engages and compresses the clutch pressure plate diaphragm spring, releasing the pressure on the clutch disc, which in turn disengages the transmission from the engine.

- The hydraulic clutch system adjusts automatically to compensate for clutch disc wear.

- The clutch pedal position (CPP) switch prevents the starter motor from engaging unless the clutch pedal is depressed all the way to the floor. The switch plunger is contacted by the clutch pedal and extends as the clutch pedal is pressed. The clutch pedal position switch is electrically connected in line with the ignition switch and the starter motor relay coil.
- The cruise control switch deactivates the speed control system and signals the electronic engine control (EEC) module when the clutch pedal is depressed.