

REMOVAL AND INSTALLATION

Front Subframe and Components — Exploded View

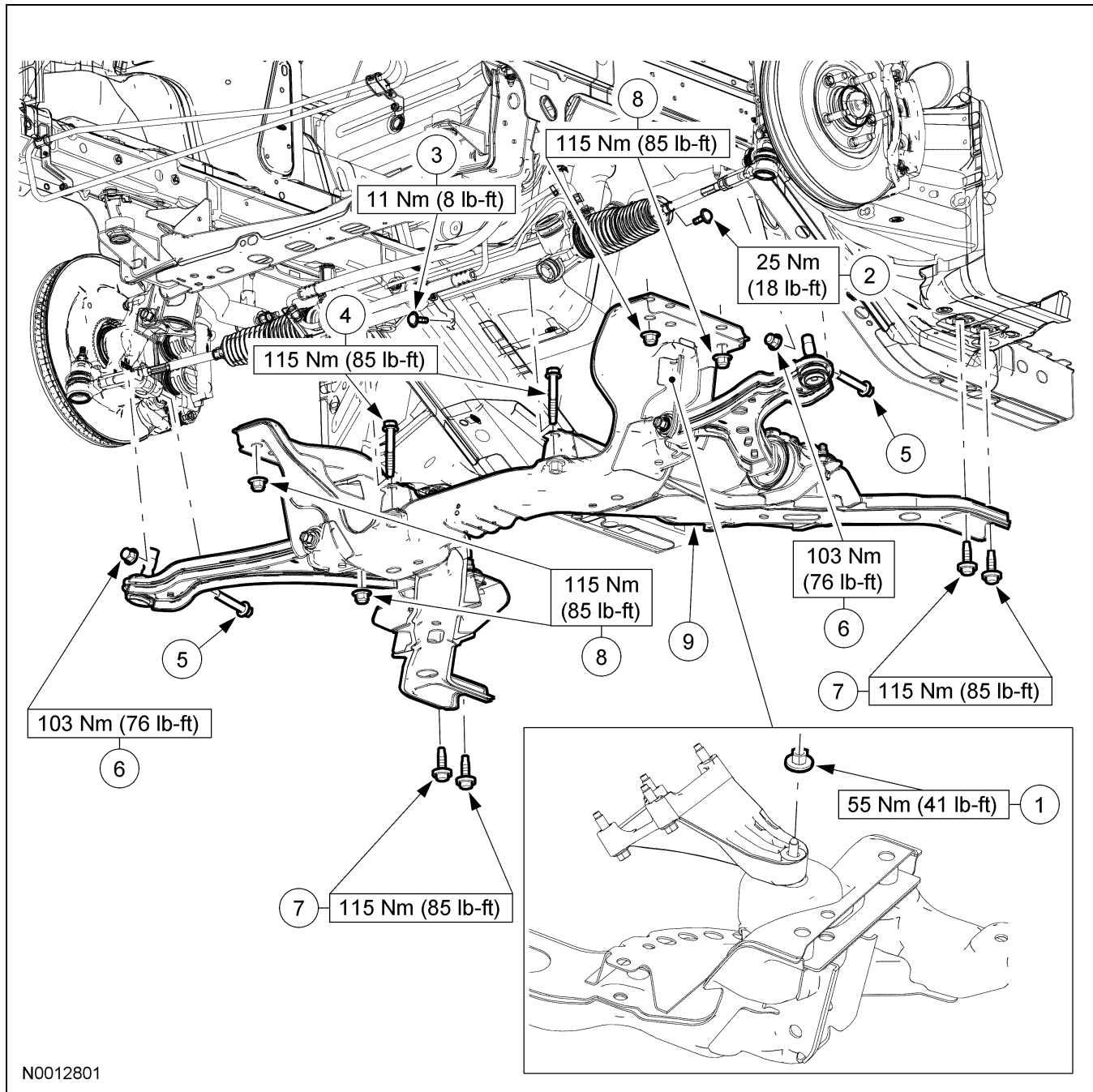

| Item | Part Number | Description |
|------|--------------|---|
| 1 | N621943-S440 | Engine mount nuts |
| 2 | 704980-S436 | Lower steering column shaft coupling bolt |
| 3 | W704980-S | Power steering line support bracket bolt |

(Continued)

| Item | Part Number | Description |
|------|-------------|-------------------------------------|
| 4 | W705315-S | Steering gear bolts (2 required) |
| 5 | W711123-S | Lower ball joint bolts (2 required) |
| 6 | W520214-S | Lower ball joint nuts (2 required) |

(Continued)

REMOVAL AND INSTALLATION (Continued)

| Item | Part Number | Description |
|------|-------------|--|
| 7 | W711075-439 | Front subframe bolts (rear) (4 required) |
| 8 | W707246-440 | Front subframe nuts (front) (4 required) |

(Continued)

| Item | Part Number | Description |
|------|-------------|----------------|
| 9 | 5025 | Front subframe |

1. For additional information, refer to the procedures in this section.