

GENERAL PROCEDURES

Quick Connect Coupling

Material

Item	Specification
SAE 5W-20 Premium Synthetic Blend Motor Oil XO-5W20-QSP	WSS-M2C930-A

Disconnect — Type I (Legris)

⚠ WARNING: Do not carry lighted tobacco or open flame of any type when working on or near any fuel-related components. Highly flammable vapors are always present and can ignite. Failure to follow these instructions may result in personal injury.

⚠ WARNING: Do not carry personal electronic devices such as cell phones, pagers or audio equipment of any type when working on or near any fuel-related components. Highly flammable mixtures are always present and may be ignited. Failure to follow these instructions can result in personal injury.

⚠ WARNING: This procedure involves fuel handling. Be prepared for fuel spillage at all times and always observe fuel handling precautions. Failure to follow these instructions may result in personal injury.

⚠ CAUTION: If the liquid or vapor tube is damaged (torn, holes or delaminated), the affected tube assembly must be replaced with a new tube assembly. Do not use aftermarket sleeving. Do not re-adhere loose sleeving material.

⚠ CAUTION: When reusing liquid or vapor tube connectors, make sure to use compressed air to remove any foreign material from the connector retaining clip area before separating from the tube. Apply clean engine oil to the end of the tube before inserting the tube into the connector.

⚠ CAUTION: Fuel injection equipment is manufactured to very precise tolerances and fine clearances. It is therefore essential that absolute cleanliness is observed when working with these components. Always install blanking plugs to any open orifices or tubes.

1. Release the fuel system pressure. For additional information, refer to Fuel System Pressure Release in this section.
2. Disconnect the battery ground cable. For additional information, refer to Section 414-01.
3. Disconnect the fuel tube quick connect coupling.
 - Press the fuel tube quick connect coupling button and pull the fuel tube to disconnect.

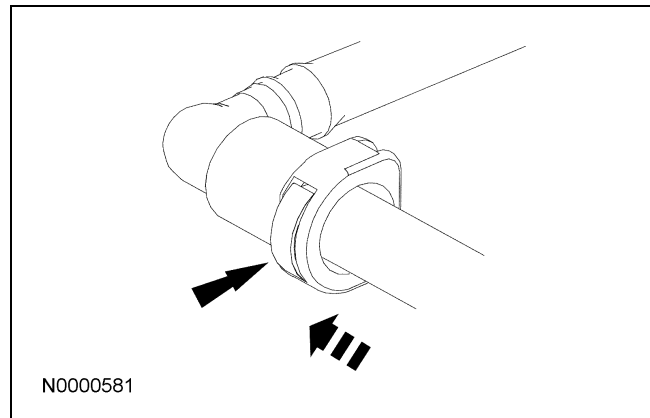

GENERAL PROCEDURES (Continued)

Connect — Type I (Legris)

1. **⚠ CAUTION:** Make sure the fuel tube clicks into place when installing the tube. To make sure that the fuel tube is fully seated, pull on the tube.

NOTE: Apply clean engine oil to O-ring seals.

Install the quick connect coupling onto the tube until it is fully seated.

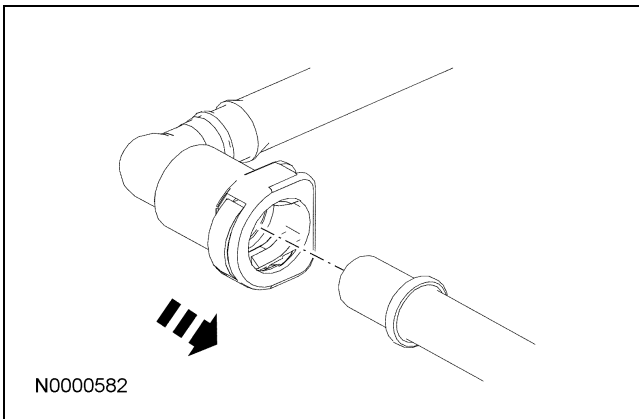

Disconnect — Type II (CONN-EMS VAC CONTR)

⚠ WARNING: Do not carry lighted tobacco or open flame of any type when working on or near any fuel-related components. Highly flammable vapors are always present and can ignite. Failure to follow these instructions may result in personal injury.

⚠ WARNING: Do not carry personal electronic devices such as cell phones, pagers or audio equipment of any type when working on or near any fuel-related components. Highly flammable mixtures are always present and may be ignited. Failure to follow these instructions can result in personal injury.

⚠ WARNING: This procedure involves fuel handling. Be prepared for fuel spillage at all times and always observe fuel handling precautions. Failure to follow these instructions may result in personal injury.

⚠ CAUTION: If the liquid or vapor tube is damaged (torn, holes or delaminated), the affected tube assembly must be replaced with a new tube assembly. Do not use aftermarket sleeving. Do not re-adhere loose sleeving material.

⚠ CAUTION: When reusing liquid or vapor tube connectors, make sure to use compressed air to remove any foreign material from the connector retaining clip area before separating from the tube. Apply clean engine oil to the end of the tube before inserting the tube into the connector.

⚠ CAUTION: Fuel injection equipment is manufactured to very precise tolerances and fine clearances. It is therefore essential that absolute cleanliness is observed when working with these components. Always install blanking plugs to any open orifices or tubes.

1. Release the fuel system pressure. For additional information, refer to Fuel System Pressure Release in this section.
2. Disconnect the battery ground cable. For additional information, refer to Section 414-01.
3. Release the lock tab on the coupling.

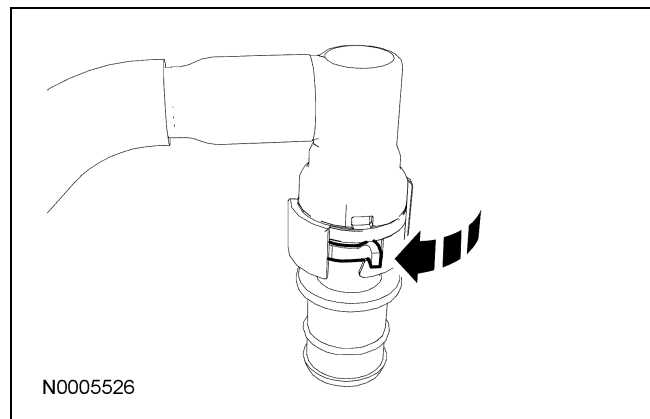

GENERAL PROCEDURES (Continued)

4. Separate the coupling from the fitting.

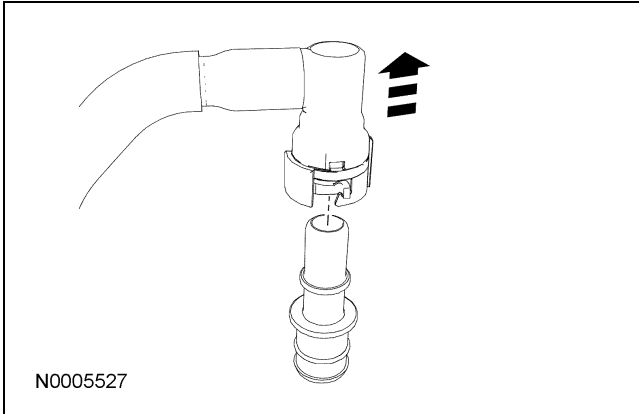
**Disconnect — Type III (ITT Posilock)**

⚠ WARNING: Do not carry lighted tobacco or open flame of any type when working on or near any fuel-related components. Highly flammable vapors are always present and can ignite. Failure to follow these instructions may result in personal injury.

⚠ WARNING: Do not carry personal electronic devices such as cell phones, pagers or audio equipment of any type when working on or near any fuel-related components. Highly flammable mixtures are always present and may be ignited. Failure to follow these instructions can result in personal injury.

Connect — Type II (CONN-EMS VAC CONTR)

1. **⚠ CAUTION:** Make sure the fuel tube clicks into place when installing the tube. To make sure that the fuel tube is fully seated, pull on the tube.

NOTE: Apply clean engine oil to O-ring seals.

Release the lock tab and install the coupling onto the fitting.

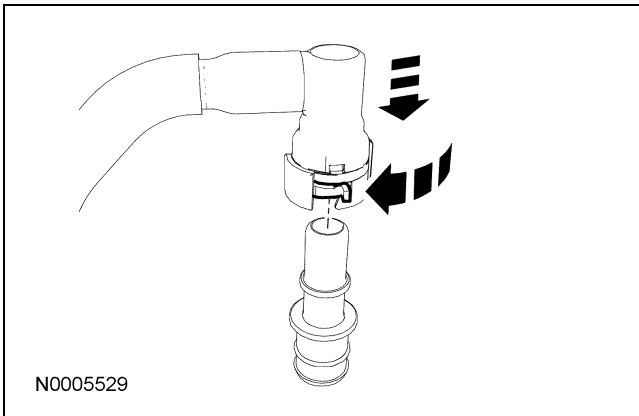

⚠ WARNING: This procedure involves fuel handling. Be prepared for fuel spillage at all times and always observe fuel handling precautions. Failure to follow these instructions may result in personal injury.

⚠ CAUTION: If the liquid or vapor tube is damaged (torn, holes or delaminated), the affected tube assembly must be replaced with a new tube assembly. Do not use aftermarket sleeving. Do not re-adhere loose sleeving material.

⚠ CAUTION: When reusing liquid or vapor tube connectors, make sure to use compressed air to remove any foreign material from the connector retaining clip area before separating from the tube. Apply clean engine oil to the end of the tube before inserting the tube into the connector.

2. Apply lock tab into the latched position.

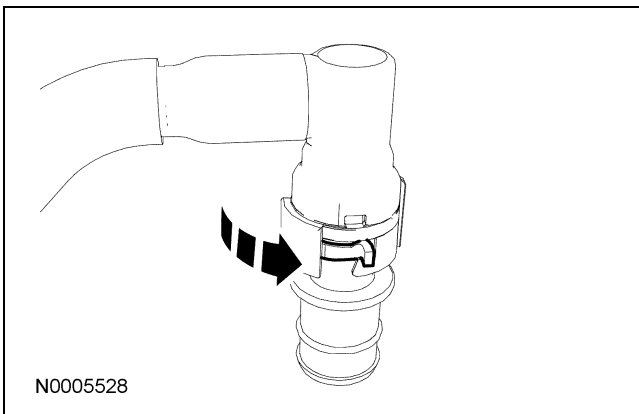

⚠ CAUTION: Fuel injection equipment is manufactured to very precise tolerances and fine clearances. It is therefore essential that absolute cleanliness is observed when working with these components. Always install blanking plugs to any open orifices or tubes.

1. Release the fuel system pressure. For additional information, refer to Fuel System Pressure Release in this section.
2. Disconnect the battery ground cable. For additional information, refer to Section 414-01.

GENERAL PROCEDURES (Continued)

3. Release the quick connect coupling lock tab.

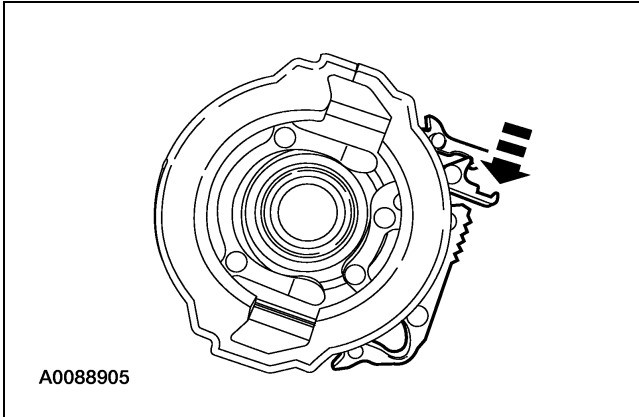

4. Rotate the primary locking tab to the fully opened position and squeeze the secondary locking tabs to release the locking mechanism.

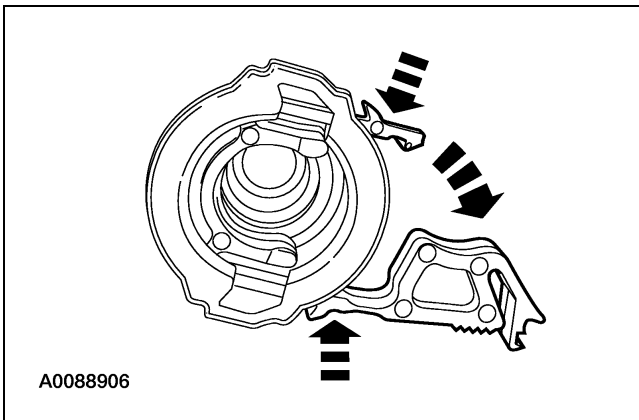

5. Push the locking mechanism outward and release the fuel supply tube.

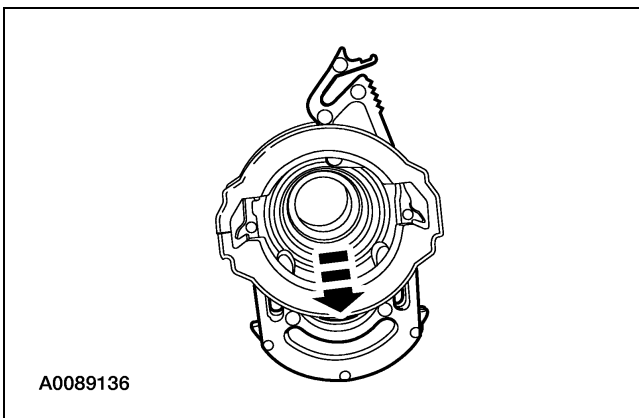
**Connect — Type III (ITT Posilock)**

1. **NOTE:** Apply clean engine oil to O-ring seals. Install the tube into the quick connect coupling until it is fully seated.
2. **CAUTION:** Make sure the retainer clip clicks into place when installing. Depress the retainer clip until it is flush with the quick connect coupler housing and it is fully seated on the tube.

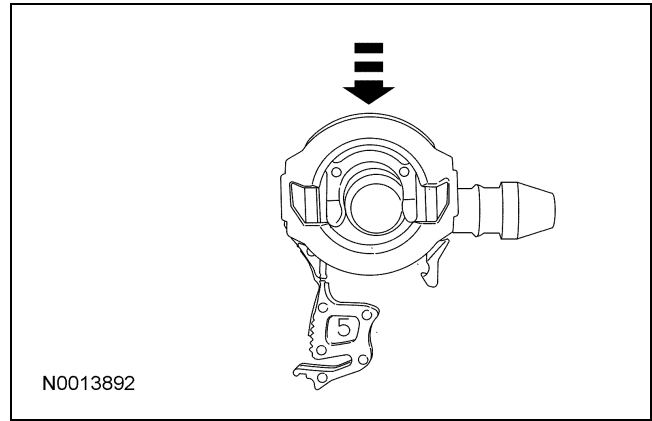

3. **CAUTION:** To make sure that the fuel tube is fully seated, pull on the tube. Rotate the primary locking tab on the retainer clip to the closed position.

